

# TECHNICAL DATA SHEET

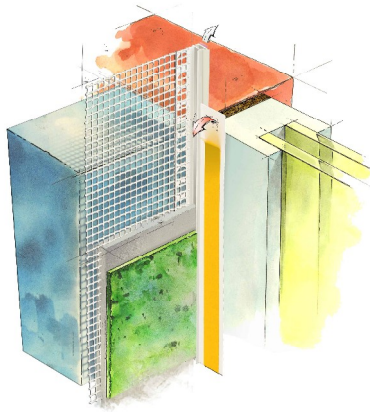
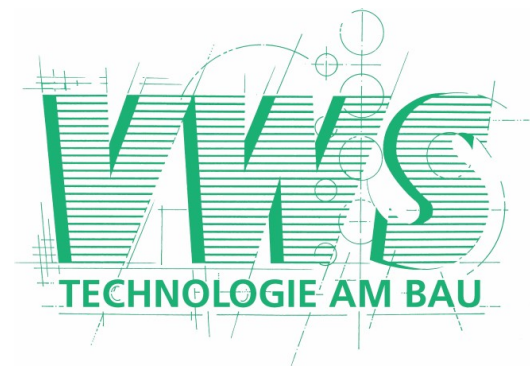

## Reveal bead Dynamik PVC with mesh Article no. 6448 and 6458

### Specifications:

Basic shape	L-profile	
Article No.	6448	6458
Lengths of profiles	2.6 m	2.6 m
Width	9 mm	6 mm
Packing unit	30 pieces	30 pieces
Packing content	78 m	78 m

### Application: thermal insulation systems / EIFS

VWS reveal beads are conducting to an exact, flush and vertically oriented termination of render to door- and window-frames. The bellows are used as an elastic connection between profile/render and door- and window-frames. After the rendering and painting work the protective plate will be bent and afterwards broken off constantly parallel to the reveal bead.

### Equipment of the product:

The VWS-reveal bead is a PVC-profile which is produced out of impact resistant and UV- and weather-proof PVC with bellows out of soft-PVC. The removable protective plate is furnished with a predetermined braking point. There is glued a double-sided tape on the protective plate to fasten a protective sheet on it during the rendering and painting work. The fibre glass reinforcement is alkali-proof and dislocation resistant.

### Important details:

Horizontal transporting and stocking!

All surfaces have to be dry and free of dust and grease!

Do not assimilate if the material, subfont and air have a temperature of less than + 5°C and over + 40°C!

Bend safety tab and demolish it evenly parallel to the reveal bead!

Reveal beads have to be assimilated within 12 months after production (see stamp on the package)!

Possible section butts must be sealed separately!

Respect the treatment instructions of the ETICS-manufacturer!

All details complies the up-to date our knowledge and experience. Our information characterise simply the character our products and don't account for contractual legal relationship. They don't absolve the customer from verifying our products to their applicability for the contemplated usage on their own. We reserve the right for changing due to technical or planning laws. Product-drawings on this sheet aren't true to scale. With publishing this technical data sheet are all back issues invalid. As of 04.2009 Rev. b (10.02.2012)